

Recommendation 3 - Item 7.3 - Attachment A

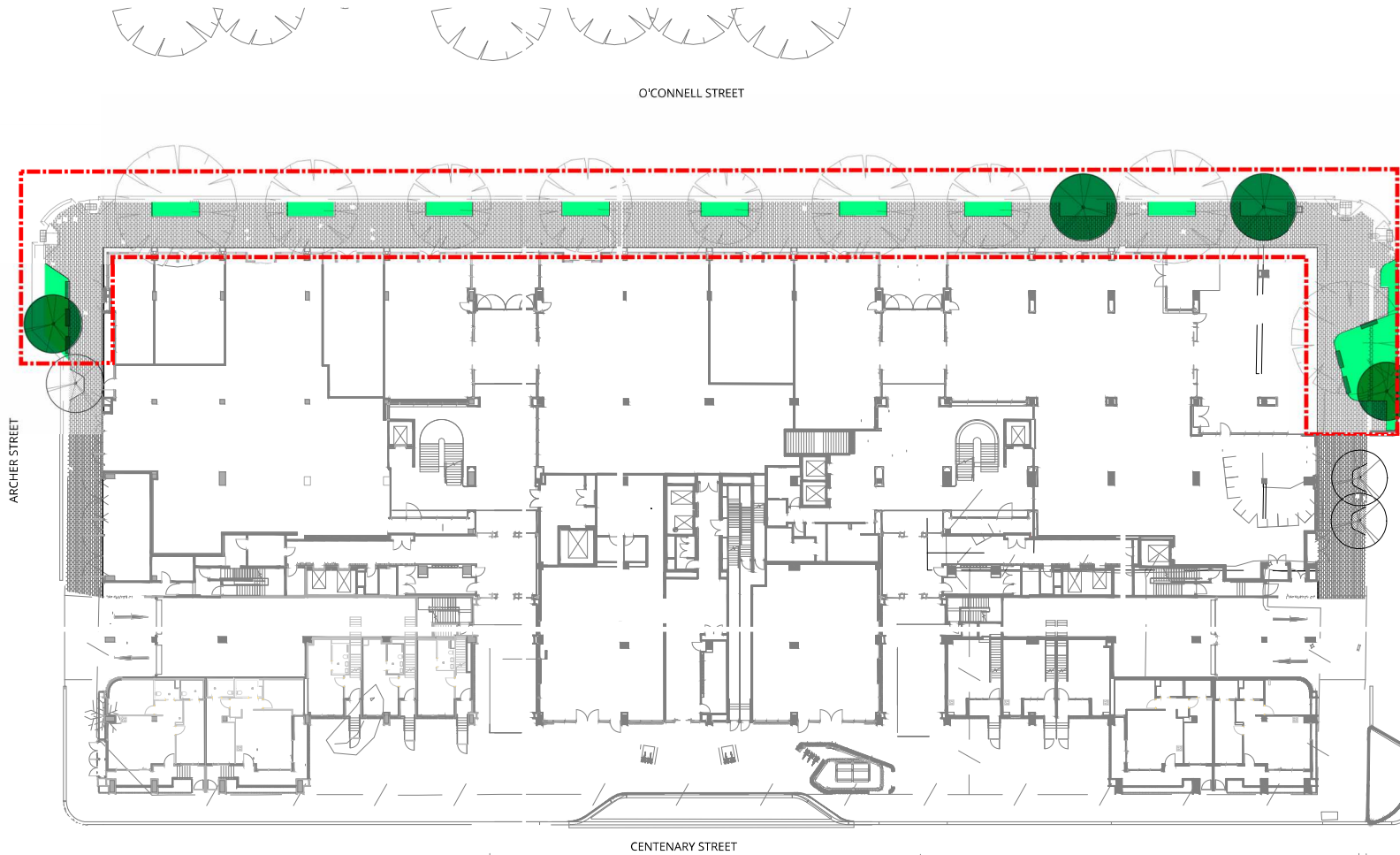

LEGEND

- EXTENT OF WORKS
- LOT LINE
- EXISTING TREE TO BE RETAINED AND PROTECTED
- NEW TREE REFER DETAIL 01.03/L201
- GARDEN BED PROFILE REFER DETAIL 02/L201
- PLANTING REFER DETAIL 01/L202
- STONESET RESIN BOUND PAVING REFER DETAIL 03/L201
- REFER MATERIALS & FINISHES SCHEDULE
- PAVING TYPE 01 REFER CITY OF ADELAIDE STANDARD DETAIL REFER 02/L202 FOR HAUNCH DETAIL

BIRDSEYE : STUDIOS

347 Unley Rd
 Malvern SA 5061
 Australia
 ABN 699 810 067 25

PH: 0400 299 376
 EMAIL: contact@birdseyestudios.com.au
 WEB: www.birdseyestudios.com.au

WARNING
 Beware of underground services. The locations of underground services are indicative only. Their exact position should be proven on site.
 Contractor to verify all dimensions on site before commencing work.
 Report all discrepancies to superintendent prior to construction. Ripped dimensions to be taken in preference to scaled drawings. All drawings may not be reproduced or distributed without prior permission from the landscape architect.

REV	DESCRIPTION	DATE
-	70% FOR COA APPROVAL	06/11/2024
A	MINOR AMENDMENTS	06/11/2024

COMMERCIAL + GENERAL
 EIGHTY EIGHT O'CONNELL - PUBLIC REALM
 EXTENT OF PUBLIC REALM WORKS - 88 OC
 70% FOR COA APPROVAL

DRAWN: CTV CHECKED: SB SCALE: A1 1:250 A3 1:500
 PLOT DATE: 05 NOVEMBER 2024 REFERENCE NO.: 21014
 DRAWING NO.: 21014.PR_L001 REVISION: A

